

Quick Reference Guide

CareSens™ N

Blood Glucose Monitoring System

No Coding 
Easy & Accurate Testing

0.5 µL 
Very Small Sample
(●: actual size shown)

5 Sec 
Rapid Test Result



1. CareSens N Blood Glucose Meter

Transmission Port

Used to transfer data from the meter to a computer with a CareSens cable

Button

Selects or changes information

S Button

Turns the meter on/off and confirms menu selections

CareSens N

alarm mem test check

88.8

mmol/L mg/dL

88.88 88.88

88.88 88.88

88.88 88.88

88.88 88.88

88.88 88.88

88.88 88.88

88.88 88.88

88.88 88.88

88.88 88.88

88.88 88.88

88.88 88.88

88.88 88.88

88.88 88.88

88.88 88.88

88.88 88.88

88.88 88.88

88.88 88.88

88.88 88.88

88.88 88.88

88.88 88.88

88.88 88.88

88.88 88.88

88.88 88.88

88.88 88.88

88.88 88.88

88.88 88.88

88.88 88.88

88.88 88.88

88.88 88.88

88.88 88.88

88.88 88.88

88.88 88.88

88.88 88.88

88.88 88.88

88.88 88.88

88.88 88.88

88.88 88.88

88.88 88.88

88.88 88.88

88.88 88.88

88.88 88.88

88.88 88.88

88.88 88.88

88.88 88.88

88.88 88.88

88.88 88.88

88.88 88.88

88.88 88.88

88.88 88.88

88.88 88.88

Display

Shows results, messages

Button

Selects or changes information

Test Strip Port

Insert test strip here

2. CareSens N Test Strip



Insert

Contact bars

Gently push the test strip, with its contact bars facing up, into the test strip port of meter

Confirmation window

Check here to see whether sufficient blood sample has been applied

Edge to apply blood sample

Apply blood sample here for testing

3. Lancing Device

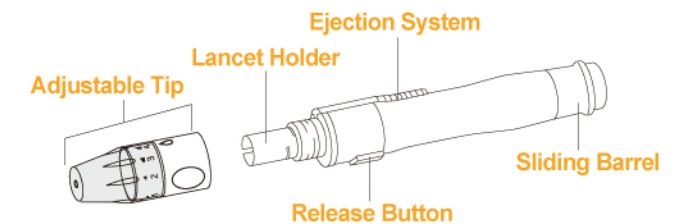

4. Preparing the Lancing Device



1 Unscrew and remove the adjustable tip.

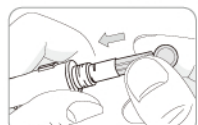

2 Insert a new disposable lancet firmly into the carrier.

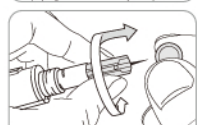

3 Twist off and set aside the protective cover of disposable lancet and replace the adjustable tip.



4 Choose a depth of penetration by rotating the top portion of the adjustable tip until the setting number matches the arrow.



5 Cock the lancing device by pulling on the sleeve until the device clicks.

5. Preparing the Meter and Test Strip



6 Wash and dry your hands.



7 Insert a test strip with the contact bars facing upwards into the meter port. The symbol will appear on the screen.

6. Applying Blood

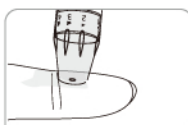

8 Obtain a blood sample using the lancing device.

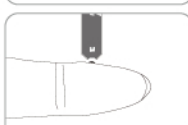

9 After the symbol appears on the screen, apply the blood sample to the narrow end of the test strip till the meter beeps. If the confirmation window hasn't filled, Er4 message will appear.



10 The test result will appear after the meter counts down from 5 to 1. The result will be automatically stored in the meter's memory.



11 Place protective cover on lancet. Push the lancet ejector forward with the thumb and simultaneously pull out the sliding barrel to dispose of used lancet in a proper biohazard container.

7. Discarding Used Lancets

7. Display and Message



The Hi icon appears when the blood glucose level is more than 600 mg/dL (33.3 mmol/L) and hyperglycemia.



The Lo icon appears when the blood glucose level is less than 20 mg/dL (1.1 mmol/L) and hypoglycemia.



The test strip has been used.
Use a new strip.



The blood sample was applied before the symbol appeared. Repeat the test with a new strip.
Wait until the symbol appears before applying blood sample.



The temperature was outside the recommended range.
Take system where the temperature is within operating range (50-104°F / 10-40°C) and repeat the test after 30 minutes.



The blood sample did not fill the confirmation window of the test strip during measurement because of abnormally high viscosity or insufficient volume.
Repeat the test with a new test strip and adequate blood sample.



A non CareSens N test strip was used.
Repeat the test with a CareSens N test strip.



There is a problem with the meter.
Do not use the meter and contact your authorized i-SENS sales representative.

Quick Guide

CareSens™ **N**

